

Electric lunch box – AS0007

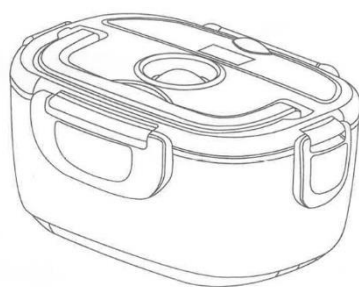

User Manual

Thank you for choosing and purchasing our product!

Please read this manual before use.

Once read, we recommend that you keep this manual for future reference!

Product Introduction

Thank you for using our electric lunch box. We research and produce in order to offer you a novel and modern product, in that sense, our product is very useful and designed for your convenience.

Product Structure

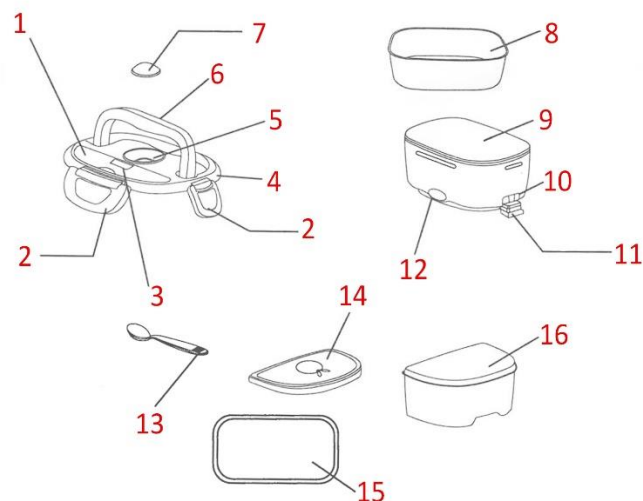

1. Spoon cover; 2. Latches; 3. Warming tips label; 4. Lunch box lid; 5. Steam outlet; 6. Handle; 7. Steam outlet cover; 8. Food; 9. Food container; 10. Plug; 11. Rubber plug of the socket; 12. Power indicator; 13. Spoon; 14. Lunch box lid; 15. Sealing ring; 16. Lunch box

How to use

(A) Heating food

1. Please put the cooked food into the rice container and then place it into the electric lunch box.
2. Please fix the lock.
3. Open the plug box and insert the power cord.
4. Turn on the power, you will see the power indicator light, the heating process has started.
Note: The heating time depends on the amount of rice, vegetables, etc. and the inside temperature.

- (1) Heating the food only needs 25 minutes in the condition of 25 degree Celsius.
- (2) When the food is taken out of the refrigerator, the heating time should be longer.
- (3) Please unplug the power cord before eating.

(B) Heating soup

1. Please put the cooked soup into the container and then into the lunch box.
2. Please close the flap.
3. Open the plug of the socket and insert the power cord.
4. Turn on the power, you will see the power indicator light, which signals that the heating process has started. Note: The heating time will depend on the amount of soup and the interior temperature.

- (1) Heating the food only needs 25 minutes in the condition of 25 degree Celsius.
- (2) When the food is taken out of the refrigerator, the heating time will vary in appropriate extent.
- (3) Please unplug the power cord before eating.

Special note

Please open the exhaust lid before heating, otherwise, the internal steam will expand in the lunch box and lead to the deformation of the lunch box, even may make it can not be used any more.

Accordingly, please open the exhaust cover whenever you heat food.

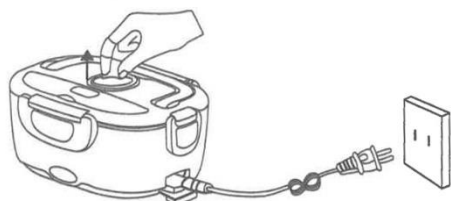

Open the exhaust cover and turn on the power.

Heating tips

If the food has been outside for a long time, it is suggested to add a little water to the rice and then put it to heat so that the rice softens.

Product Features

1. With subtle design appearance.
2. Bring special heating style, which can even the temperature and soften the food.
3. Adopt conservation container design, convenient and easy to carry.
4. The inside of the food container is made of heat-resistant material, which meets the safety standards of ROHS and FDA certifications.

Cleaning and maintenance

1. Don't forget to unplug the power plug when you finish heating.
2. Please clean up at once to avoid peculiar odor generation.
3. Do not use thinner, gasoline, cleaner, hard brushes or stainless steel wire cleaning sponge to clean.
4. You can use some warm water or soft damp cloth to clean it.
5. When not to be used for a long time, please clean it and put it in the packing box, then put it in a cool and ventilated place.
6. If there is any problem with the lunch box, please send it to our designated maintenance service department for repair, do not repair it by yourself.

Safety Precautions

1. Please make sure the rated voltage is the same as yours.
2. If the power cord is damaged, you should use a new one to replace the power cord.
3. Do not use the lunch box near flammable items.
4. Do not plug and unplug the power plug when your hands are wet.
5. Do not immerse the product in water to wash it, this will damage the appliance.
6. Do not modify, disassemble or repair this product by yourself.
7. Do not use the lunch box in uneven or damp places.
8. It is forbidden to disinfect it in high temperature sterilization equipment.
9. Do not heat the lunch box in a microwave oven.
10. Do not freeze the lunch box in the refrigerator.
11. Do not turn on the lunch box when there is no food inside.

Troubleshooting

1. Fault: Indicator does not light up when plugged in.

Cause: a. Failure to plug in; b. Damaged power cord

Solution: Check the socket, the power cord and plug it in again.

2. Fault: Indicator does not light up when switched on

Cause: a. Resistor is damaged

Solution: Send to the designated department for maintenance

3. Fault: Temperature is too low after heating.

Cause: a. The heating time is too short; b. Both ambient and food temperature is too low.

Solution: Extend the heating time.

Tip:

When using the lunch box, it is recommended to open the lid with both hands at the same time, not just one side; similarly, close the lid of the lunch box with both hands, not one.

